



Memorandum

ADS Emerald Park Landfill Audit Summary

To: ADS Emerald Park Landfill Standing Committee, City of Muskego
FROM: Faith Spear.
COPIES: File
DATE: 2/21/18
PROJECT NUMBER: 1012.10030

Attached is the audit report for activities at the ADS Emerald Park Landfill for the week of December 17, 2017. The audit was performed at 11:55 AM on **December 18, 2017** by Jo Spear, Jr. in the presence of Michael Hackney, General Manager.

Landfill Operations Audit:

The following conditions were noted during this Audit of the VEPL Facility:

- Overcast day with occasional bursts of sunlight
- Working face at junction of Phase 6 and 7 just South of Phase 4
 - All wastes tipped in this face
- Previous faces covered with mix of fluff and sand
- One compactor, one dozer, one excavator and one haul truck in use on site
- Bio-soils from stockpile in Phase 3 used for daily cover

- All leachate discharging to MMSD; no recirculation
- Gas plant was shut down prior to audit
 - For installation of Hydrogen Sulfide pots
 - Plant was successfully restarted at 12:15, during audit
 - One blower in operation; no flares during audit
 - Gas delivery resumed

- Several small snow events since last audit
 - Site dry and frozen
 - Basin 3 requires cleaning
- Gas odor about Phase 7
- Liquid loads tipped in working face

- Litter on-site; clear off-site
 - Majority of litter in on-site trees
 - Litter on Eastern slopes
- One litter picker working
- US 45 and 8 Mile Road clean; site roads dusty
 - Pot holes in site entrance area

Attachments:

Action Items List / Landfill Operations Audit Form
Audit Photos

- Scale camera in use; 3 equipment operators; no spotter
 - Receiving approximately 1,700 TPD
 - Incoming waste composed of MSW, C&D and small volume of Special Wastes
 - No rejected loads
- Residential drop-off site clean
 - E-waste container emptied during audit

Comments:

- Site will be closed on 12/25/17 and 1/1/18; extended hours on 12/30/17 and 1/6/18
 - Extended times to compensate for closing on holidays
- Odors are due to recent gas plant shut-down
 - Expect odor problem to cease with plant back on-line today
- Approval expected to begin placement of waste in Phase 7 South this week

Attachments:

Action Items List / Landfill Operations Audit Form
Audit Photos

**ADS Emerald Park Landfill
Action Items Checklist
City of Muskego Audit**

Opened:

Updated: 01/09/2014 - Cleared

Item Number	DATE month/date/year	Condition Description	Permit or Contract Reference	Initial Schedule for Completion	Observed Completion Date	Elapsed Time (Days)	Notes

ADVANCED DISPOSAL SERVICES EMERALD PARK LANDFILL
 LANDFILL OPERATIONS AUDIT FORM
 CITY OF MUSKEGO

PROJECT NO. 1020.10030

DATE December 18, 2017
 Auditor on site at: Open Close

TIME 11:55

WEATHER Overcast, Occasional Sun

WIND 10-20
 N E

TEMP Maximum 41 °F Minimum 35 °F B.P. 29.89

MAJOR EQUIPMENT USED IN LANDFILL OPERATIONS

No.	DESCRIPTION	Rented	Contracted	No.	DESCRIPTION	Rented	Contracted
1	Compactor						
1	Dozer						
1	Excavator						
1	Haul Truck						
	Water Truck						
	Grader						

MAJOR EQUIPMENT BONEYARD

No.	DESCRIPTION	Broken	Maintenance	No.	DESCRIPTION	Broken	Maintenance

A. Working Face Size and Location:

*Working face at Phase 6 & 7 junction
 South of Phase 4 receiving all
 Wastes. Previous faces covered with
 a mix of Polyfluff and sand*



Cover Material:

Bio soil from pile in Phase 3

B. Leachate Management:

Discharge to MMSD Recirculation

Phases:

C. Gas Monitoring and Management: Check appropriate box.

Flares in Operation:	YES <input type="checkbox"/>	NO <input type="checkbox"/>	#	
Blowers in Operation:	YES <input checked="" type="checkbox"/>	NO <input type="checkbox"/>	#	1
Flare use since last audit	#		1	
Shutdowns Since Last Audit:	#		1	
Flow to MMSD:	#			cfm

Comments:

Plant down just before audit to install H₂S pots Back online by 12:15

D. Surface Water Management:

Storm Events Since Last	#	Est. Volume
-------------------------	---	-------------

EFFECTS: Note condition of perimeter road, erosion control structures, erosion damage and possible storm water/waste contact locations:

~~Small~~ Small snow events since last audit. Site frozen Basin 3 requires cleaning

E. Odor Control:

Odors Present: Onsite Offsite

Comments:

Gas odor about Phase 3

F. Liquid Loads Received:

Tipped to Working face

G. Litter Control:

Litter Present Onsite:	YES	<input checked="" type="checkbox"/>	NO	<input type="checkbox"/>	
Litter Present Offsite:	YES	<input type="checkbox"/>	NO	<input checked="" type="checkbox"/>	
Pickers Active:	YES	<input checked="" type="checkbox"/>	NO	<input type="checkbox"/>	# 1

Comments:
 Litter about East trees on site
 and some Eastern slopes

H. Vehicle Impacts: Locations of excessive mud/dust, condition of access and public roads and control measures taken, instances of trucks on County roads.

US 45 1/2 mile clear
 Site entrance potholed

I. Inspection of incoming Waste:

Scale Camera Operator:	YES	<input checked="" type="checkbox"/>	NO	<input type="checkbox"/>	#	1	
Equipment Operator:	YES	<input checked="" type="checkbox"/>	NO	<input type="checkbox"/>	#	3	
Spotter:	YES	<input type="checkbox"/>	NO	<input checked="" type="checkbox"/>	#		
Random Load Inspection Dates:						Form	<input type="checkbox"/>
Tonnage:	1,700 YPD						

Comments:
 MSW, C&D, small volume special

J. Rejected Loads:

	Date/Time	Reason for Rejection
1.		None
2.		

L. Residential Drop Off: Open During Audit E-Waste Container Present

Area clear, E-waste container being emptied during audit

M. Other Comments:

* Reminder, site closed 12/18; expect late operations on 12/30

* Orders due to plant shut down, expect orders to cease with plant output

* Phase 7 South approval expected this week

Auditor's Signature:

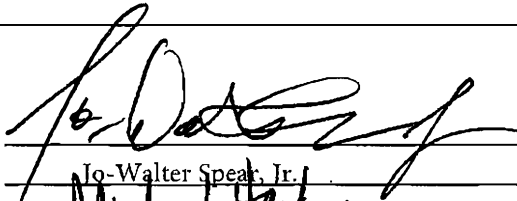

Date: 12/18/17

Auditor's Printed Name:

Jo-Walter Speak, Jr.

Management Signature:

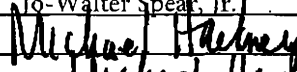

Date: 12/18/17

Management Printed Name:

Michael Hadney

Management Title:

GM

JSA Principal Signature:

Date: _____

ADSEMERALD PARK LANDFILL LANDFILL AUDIT MAP CITY OF MUSKEGO

PROJECT NO. 1020.10030

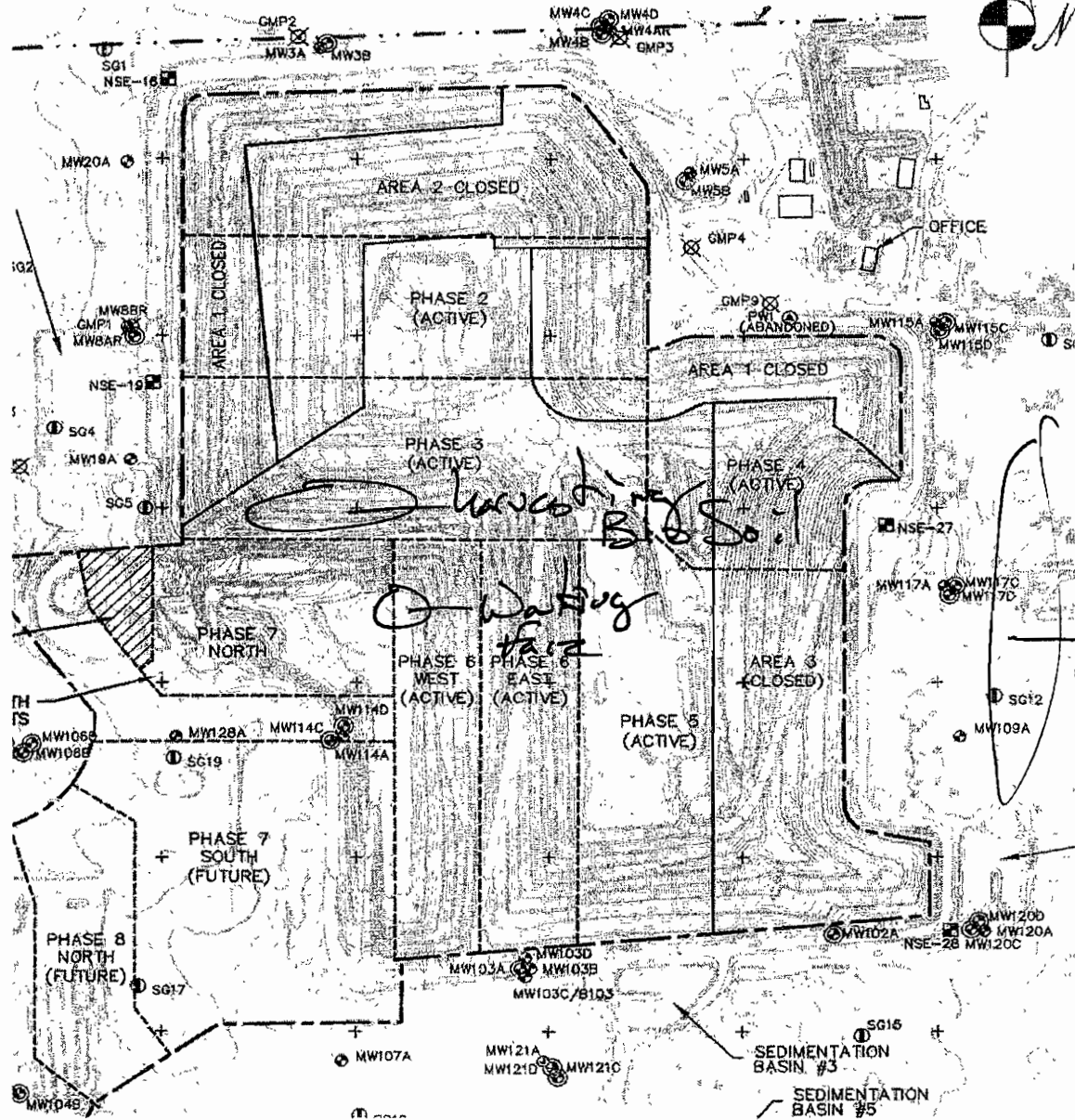

JSA
 WWW.JSACIVIL.COM
 325 WEST VINE STREET
 MILWAUKEE, WI 53212-3606
 CIVIL ENVIRONMENTAL
 ENGINEERS

LANDFILL AUDIT MAP

**ADVANCED DISPOSAL SERVICES
EMERALD PARK LANDFILL / CITY OF MUSKEGO
AUDIT PHOTOS**

PROJECT NO. 1012.10030



Working face along Phase 6/7 border, note litter fences at top of slope.





Active area viewed from Northwest, working face to the North (Left)



Roll off boxes staged on Phase 7 during road construction.



Active area, Phase 7



Previous days working face covered with sand and poly-fluff mix (MRF fines)



Expansion complete and awaiting DNR approval before waste placement



New expansion, East side, awaiting approval prior to waste placement