



Memorandum

ADS Emerald Park Landfill Audit Summary

To: ADS Emerald Park Landfill Standing Committee, City of Muskego
FROM: Faith Spear.
COPIES: File
DATE: 08/19/15
PROJECT NUMBER: 1012.10030

Attached is the audit report for activities at the ADS Emerald Park Landfill for the week of July 20, 2015. The audit was performed at 11:42 AM on **July 22, 2015** by Jo Spear, Jr. in the presence of Brett Coogan, Plant Manager.

Landfill Operations Audit:

The following conditions were noted during this Audit of the VEPL Facility:

- Working face for MSW in middle of Phase 7Be.
 - Receiving MSW and Special Wastes
 - Small loads of Bio-Soils tipped in Phase 3
- One compactor & two dozer working on site
 - One D6 and one backhoe waiting for repairs
- Current daily cover is soils, sands and polyfluff

- All leachate discharging to MMSD; no recirculation
- Medium replacement operation complete
- Gas flow to MMSD consistent except during recovery from media replacement
 - Gas flow to MMSD approximately 1,500 cfm
 - No flares in operation during audit; One blower in operation
 - Vegetation in fair condition

- Two storm events since last audit; about 1.5"
 - Basins have plenty of free-board
 - No new erosion
- Sour waste odor around active area
- Liquid loads periodic

- Some litter visible on-site; clear off-site
 - Litter minimal; site condition good
 - Two pickers working; one operating residential drop-off area
- US 45 and 8 Mile Road clean; site roads dusty

- Scale camera in use; 3 equipment operators; no spotter
 - Receiving approximately 1,600 TPD

Attachments:

Action Items List / Landfill Operations Audit Form
Audit Photos

- Incoming loads composed of MSW, Special wastes, liquid loads and bio-soils
- Random load inspection information not available
- No rejected loads

- Residential drop-off site clean
 - E-waste container present
 - open until Friday; accepting brush only

Comments:

- Cover soils delivery greatly reduced
 - Random bio-soil loads today

- Soil cover project around Phase 7 drainage layer completed

Attachments:

Action Items List / Landfill Operations Audit Form
Audit Photos

VEOLIA Emerald Park Landfill
Action Items Checklist
City of Muskego Audit

Opened:

Updated: 01/09/2014 - Cleared

Item Number	DATE <small>month/date/year</small>	Condition Description	Permit or Contract Reference	Initial Schedule for Completion	Observed Completion Date	Elapsed Time (Days)	Notes



ADVANCED DISPOSAL SERVICES EMERALD PARK LANDFILL
 LANDFILL OPERATIONS AUDIT FORM
 CITY OF MUSKEGO

PROJECT NO. 1020.10030

DATE July 22, 2015
 Auditor on site at: Open Close

TIME 11:42

WEATHER High clouds, sunny

WIND 0-5
 N E W

TEMP Maximum 79 °F Minimum 64 °F B.P. 29.98

MAJOR EQUIPMENT USED IN LANDFILL OPERATIONS

No.	DESCRIPTION	Rented	Contracted	No.	DESCRIPTION	Rented	Contracted
<u>1</u>	Compactor						
<u>2</u>	Dozer						
	Excavator						
	Haul Truck						
	Water Truck						
	Grader						

MAJOR EQUIPMENT BONEYARD

No.	DESCRIPTION	Broken	Maintenance	No.	DESCRIPTION	Broken	Maintenance
<u>1</u>	<u>Dozer</u>	<input checked="" type="checkbox"/>					
<u>1</u>	<u>Backhoe</u>	<input checked="" type="checkbox"/>					

A. Working Face Size and Location:
Working face for MSW in middle of Phase 7B
receiving MSW & Special Wastes.
Bio soils being tipped in Phase 3, small
loads.



Cover Material:

Soils, Sandy, Poly Staff

B. Leachate Management:

Discharge to MMSD	<input checked="" type="checkbox"/>	Recirculation	<input type="checkbox"/>
-------------------	-------------------------------------	---------------	--------------------------

Phases:

C. Gas Monitoring and Management: Check appropriate box.

Flares in Operation:	YES <input type="checkbox"/>	NO <input checked="" type="checkbox"/>	#	
Blowers in Operation:	YES <input checked="" type="checkbox"/>	NO <input type="checkbox"/>	#	1
Flare use since last audit	#	1		
Shutdowns Since Last Audit:	#	NA		
Flow to MMSD:	#	1,500	cfm	
Vegetation Condition:	Good <input type="checkbox"/>	Fair <input checked="" type="checkbox"/>	Poor <input type="checkbox"/>	Dead <input type="checkbox"/>

Comments:

Medium replacement complete. Delivery consistent except for recovery times.

D. Surface Water Management:

Storm Events Since Last	#	2	Est. Volume	~1.8'
-------------------------	---	---	-------------	-------

EFFECTS: Note condition of perimeter road, erosion control structures, erosion damage and possible storm water/waste contact locations:

Basins have plenty of free board. No new erosion

E. Odor Control:

Odors Present:	Onsite <input type="checkbox"/>	Offsite <input checked="" type="checkbox"/>
----------------	---------------------------------	---

Comments:

Odors, sour waste, around active area

F. Liquid Loads Received:

Periodic

G. Litter Control:

Litter Present Onsite:	YES	<input checked="" type="checkbox"/>	NO	<input type="checkbox"/>	
Litter Present Offsite:	YES	<input type="checkbox"/>	NO	<input checked="" type="checkbox"/>	
Pickers Active:	YES	<input checked="" type="checkbox"/>	NO	<input type="checkbox"/>	# 2

Comments:

Litter conditions good.
 Picker operating resi-drop off

H. Vehicle Impacts: Locations of excessive mud/dust, condition of access and public roads and control measures taken, instances of trucks on County roads.

US 45 & 8 Mile Road Clean, site roads dusty

I. Inspection of incoming Waste:

Scale Camera Operator:	YES	<input checked="" type="checkbox"/>	NO	<input type="checkbox"/>	#	1
Equipment Operator:	YES	<input checked="" type="checkbox"/>	NO	<input type="checkbox"/>	#	3
Spotter:	YES	<input type="checkbox"/>	NO	<input checked="" type="checkbox"/>	#	
Random Load Inspection Dates:	NA					
Tonnage:	1,600 TPD					

Comments:

Mow Special Wastes, liquid loads, and BioSoils.

J. Rejected Loads:

	Date/Time	Reason for Rejection
1.		None
2.		

L. Residential Drop Off: Open During Audit E-Waste Container Present

Resi drop off open until Friday for brush only

M. Other Comments:

* ~~Soil~~ cover soils delivery nearly ended

random bio soil today

* Soil cover now complete about

Phase 7 Drainage layer.

Auditor's Signature:

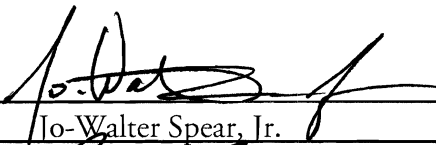

Auditor's Printed Name:

Walter Spear, Jr.

Date:

7/22/15

Management Signature:

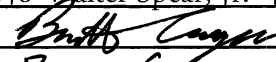

Management Printed Name:

Brent Coburn

Date:

7/23/15

Management Title:

Plant Manager

JSA Principal Signature:

Date:

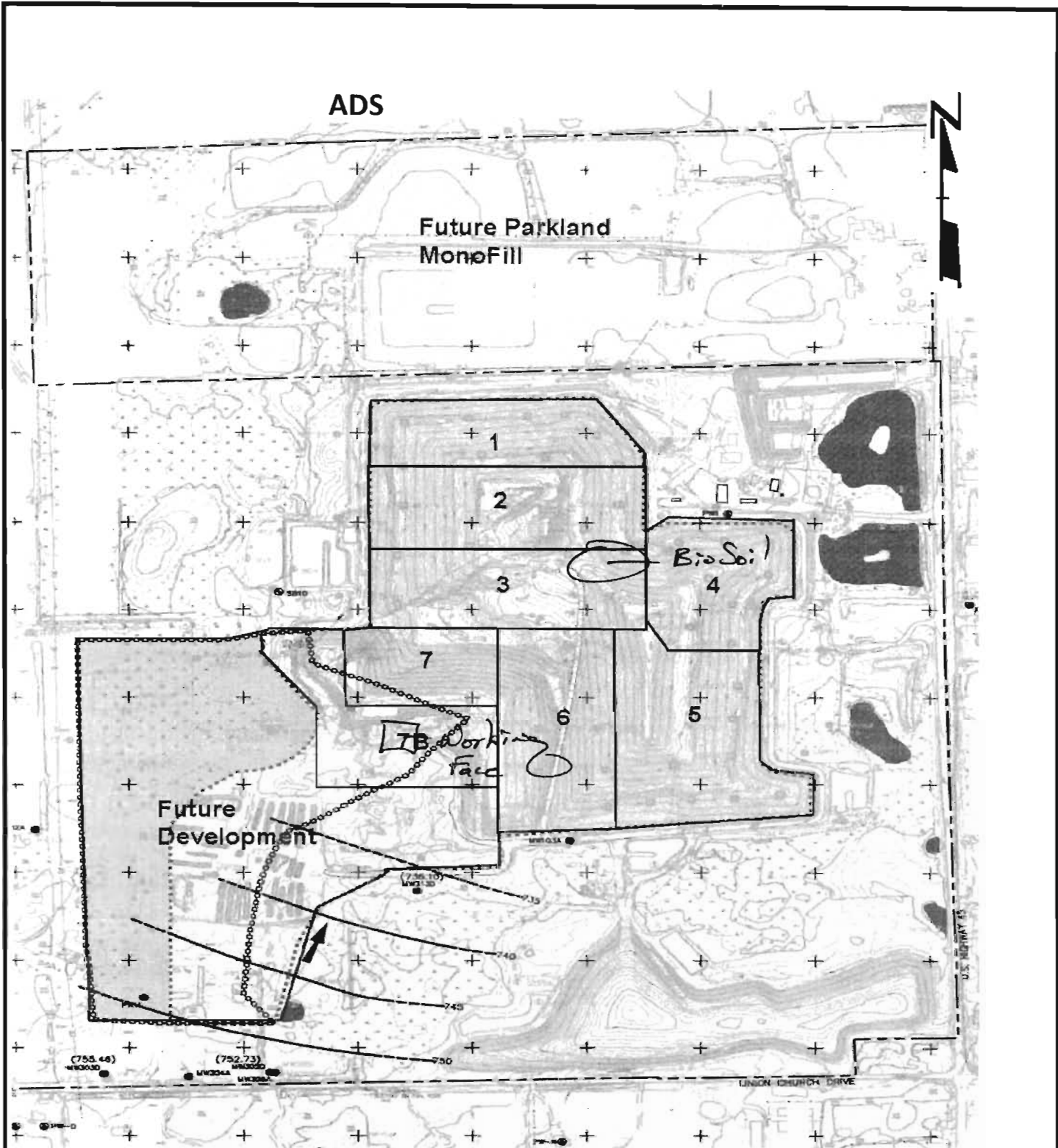

Advanced Disposal Services Emerald Park Landfill
 Landfill Audit Map
 City of Muskego
 Project No. 1020.10030



**ADVANCED DISPOSAL SERVICES
EMERALD PARK LANDFILL / CITY OF MUSKEGO
*AUDIT PHOTOS***

PROJECT NO. 1012.10030



Bio Soil tipped in Phase 3



Soil placement over Phase 5/6 trickled to less than one load per day



Active area viewed from West



Active area viewed from Northeast



Gas well in Phase 7, requires extension before additional waste can be placed in the area



Working face viewed from East



Working face viewed from West



New slope over drainage layer, some flagging



West slope of Phase 7B, waste and cover placement extended out over drainage blanket (stone)