



Memorandum

ADS Emerald Park Landfill Audit Summary

To: ADS Emerald Park Landfill Standing Committee, City of Muskego
FROM: Faith Spear.
COPIES: File
DATE: 06/03/15
PROJECT NUMBER: 1012.10030

Attached is the audit report for activities at the ADS Emerald Park Landfill for the week of May 11, 2015. The audit was performed at 11:25 PM on **May 14, 2014** by Jo Spear, Jr. in the presence of Brett Coogan, Plant Manager.

Landfill Operations Audit:

The following conditions were noted during this Audit of the VEPL Facility:

- Working face in middle of Phase 7
 - On and above South slope
 - No other active faces on site
- Soils plentiful around active area
- One compactor, one dozer and two excavators working on site
- Using site soils for daily cover

- All leachate discharging to MMSD; no recirculation
- Gas production and recovery consistent with periodic regeneration of system
 - 1,500 cfm delivered
 - No flares in use
 - One blower in operation
 - Vegetation improving
 - cooler temperatures have improved gas delivery

- One storm event since last audit; about 1"
 - No additional erosion
 - Seeding activity on-going
- No odors on-site
- Liquid loads periodic

- Minimal litter on-site; clear off-site
- Two pickers working
- US 45 clean;
 - 8 Mile Road has tracking
 - Probably from contractors working on residential properties

Attachments:

Action Items List / Landfill Operations Audit Form
Audit Photos

- Scale camera in use; equipment operators; no spotter
 - Receiving approximately 2,200 tpd
 - Mixture of MSW, special handling and C&D
 - No rejected loads
- Residential drop-off site clean
 - E-waste container present
 - Boxes mostly empty

Comments:

- Soil job completed
 - No additional loads of bio-soils anticipated
 - Two separate back hauls continuing
 - Trucks loaded by Emerald Park
 - Using main entrance
- Seeding contractor nearly finished

Attachments:

Action Items List / Landfill Operations Audit Form
Audit Photos

VEOLIA Emerald Park Landfill
Action Items Checklist
City of Muskego Audit

Opened:

Updated: 01/09/2014 - Cleared

| Item Number | DATE month/date/year | Condition Description | Permit or Contract Reference | Initial Schedule for Completion | Observed Completion Date | Elapsed Time (Days) | Notes |
|-------------|-------------------------|-----------------------|------------------------------------|--|--------------------------------|---------------------------|-------|
| | | | | | | | |
| | | | | | | | |
| | | | | | | | |
| | | | | | | | |
| | | | | | | | |
| | | | | | | | |
| | | | | | | | |
| | | | | | | | |
| | | | | | | | |



ADVANCED DISPOSAL SERVICES EMERALD PARK LANDFILL
 LANDFILL OPERATIONS AUDIT FORM
 CITY OF MUSKEGO

PROJECT NO. 1020.10030

DATE May 14, 2015

TIME 12:25

Auditor on site at: Open Close

WEATHER Overcast, high clouds, occasional sun

WIND 10-25
 N S E W

TEMP Maximum 57 °F Minimum 49 °F B.P. 30.39

MAJOR EQUIPMENT USED IN LANDFILL OPERATIONS

| No. | DESCRIPTION | Rented | Contracted | No. | DESCRIPTION | Rented | Contracted |
|----------|-------------|--------|------------|-----|-------------|--------|------------|
| <u>1</u> | Compactor | | | | | | |
| <u>1</u> | Dozer | | | | | | |
| <u>2</u> | Excavator | | | | | | |
| | Haul Truck | | | | | | |
| | Water Truck | | | | | | |
| | Grader | | | | | | |

MAJOR EQUIPMENT BONEYARD

| No. | DESCRIPTION | Broken | Maintenance | No. | DESCRIPTION | Broken | Maintenance |
|-----|-------------|--------|-------------|-----|-------------|--------|-------------|
| | | | | | | | |
| | | | | | | | |
| | | | | | | | |

A. Working Face Size and Location:

Working face in middle of Phase 7 on
and above south slope.
No other working faces on site



Cover Material:

Soils plentiful about working face

B. Leachate Management:

| | | | |
|-------------------|-------------------------------------|---------------|--------------------------|
| Discharge to MMSD | <input checked="" type="checkbox"/> | Recirculation | <input type="checkbox"/> |
|-------------------|-------------------------------------|---------------|--------------------------|

Phases:

C. Gas Monitoring and Management: Check appropriate box.

| | | | | |
|-----------------------------|---|--|-------------------------------|-------------------------------|
| Flares in Operation: | YES <input type="checkbox"/> | NO <input checked="" type="checkbox"/> | # | |
| Blowers in Operation: | YES <input checked="" type="checkbox"/> | NO <input type="checkbox"/> | # | 1 |
| Flare use since last audit | # Regen Only | | | |
| Shutdowns Since Last Audit: | # " " " | | | |
| Flow to MMSD: | # 1,560 | | cfm | |
| Vegetation Condition: | Good <input type="checkbox"/> | Fair <input checked="" type="checkbox"/> | Poor <input type="checkbox"/> | Dead <input type="checkbox"/> |

Comments:

Gas production and delivery consistent with periodic regen of system.

D. Surface Water Management:

| | | | |
|-------------------------|-----|-------------|-----|
| Storm Events Since Last | # 1 | Est. Volume | 21" |
|-------------------------|-----|-------------|-----|

EFFECTS: Note condition of perimeter road, erosion control structures, erosion damage and possible storm water/waste contact locations:

No additional erosion, Seeding onsite ongoing activity

E. Odor Control:

| | | |
|----------------|---------------------------------|----------------------------------|
| Odors Present: | Onsite <input type="checkbox"/> | Offsite <input type="checkbox"/> |
|----------------|---------------------------------|----------------------------------|

Comments:

No odors onsite

F. Liquid Loads Received:

Periodic

G. Litter Control:

| | | | |
|-------------------------|---|--|-----|
| Litter Present Onsite: | YES <input checked="" type="checkbox"/> | NO <input type="checkbox"/> | |
| Litter Present Offsite: | YES <input type="checkbox"/> | NO <input checked="" type="checkbox"/> | |
| Pickers Active: | YES <input checked="" type="checkbox"/> | NO <input type="checkbox"/> | # 2 |

Comments:
 Litter minimal, pickers active

H. Vehicle Impacts: Locations of excessive mud/dust, condition of access and public roads and control measures taken, instances of trucks on County roads.

US 43 clean, 5 Mile has fracking, probably from contractors working on residential properties

I. Inspection of incoming Waste:

| | | | |
|-------------------------------|---|--|---|
| Scale Camera Operator: | YES <input checked="" type="checkbox"/> | NO <input type="checkbox"/> | # |
| Equipment Operator: | YES <input checked="" type="checkbox"/> | NO <input type="checkbox"/> | # |
| Spotter: | YES <input type="checkbox"/> | NO <input checked="" type="checkbox"/> | # |
| Random Load Inspection Dates: | NA | | |
| Tonnage: | 2,200 TPD | | |

Comments:
 MSW, special wastes, and (E)

J. Rejected Loads:

| | Date/Time | Reason for Rejection |
|----|-----------|----------------------|
| 1. | | None |
| 2. | | |

L. Residential Drop Off: Open During Audit E-Waste Container Present

Drop off clean, boxes mostly empty

M. Other Comments:

- * Soil job completed, No additional Bio Soil
- * Back haul ongoing, two separate back hauls, loaded by Emerald Park. Trucks using main entrance.
- * Seeding contractor nearly complete

Auditor's Signature:

Auditor's Printed Name:

Jo-Walter Spear, Jr.

Date: 5/14/15

Management Signature:

Management Printed Name:

Brent Colgan

Date: 5/14/15

Management Title:

Plant Manager

JSA Principal Signature:

Date:

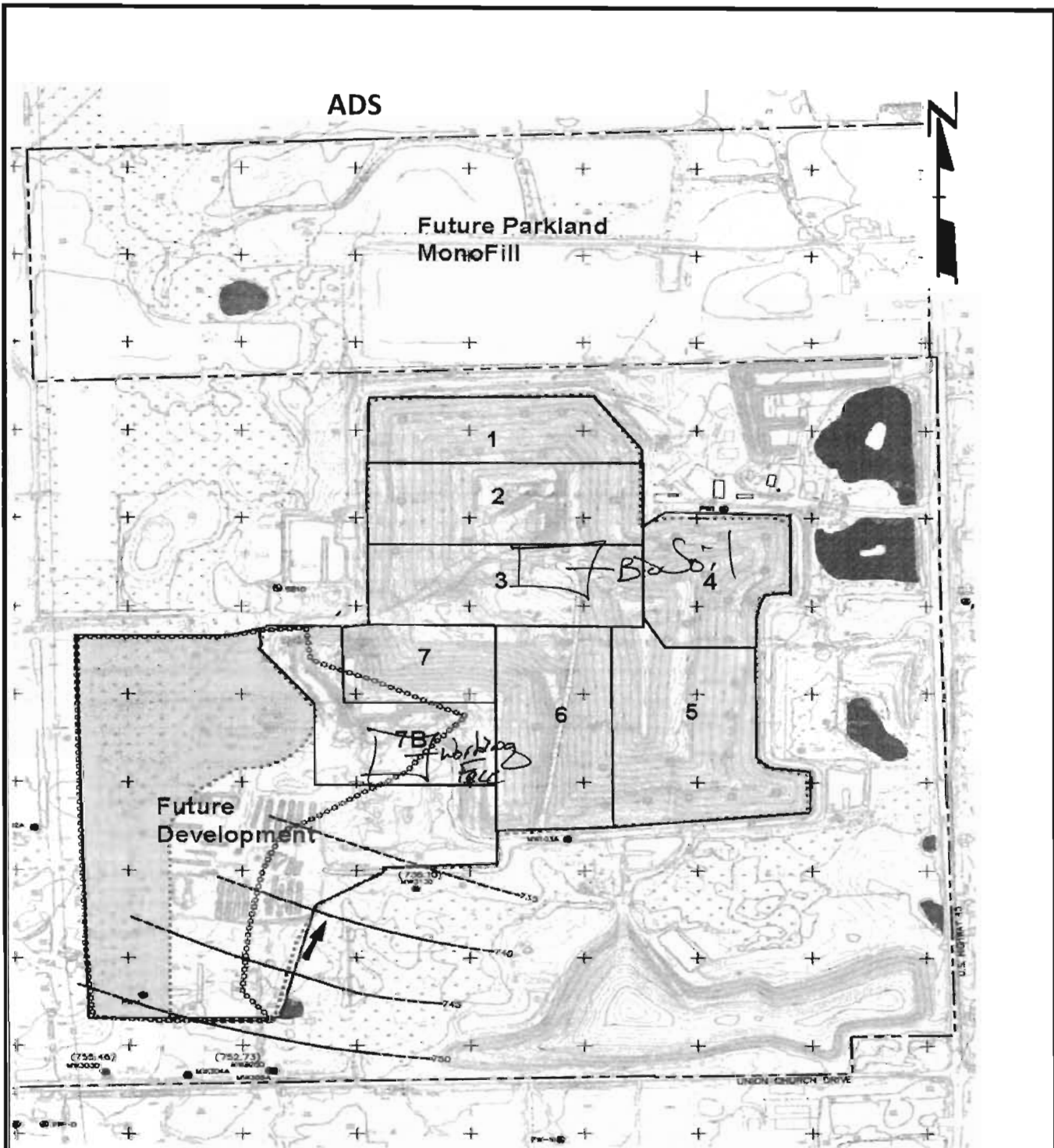

Advanced Disposal Services Emerald Park Landfill
 Landfill Audit Map
 City of Muskego
 Project No. 1020.10030



**ADVANCED DISPOSAL SERVICES
EMERALD PARK LANDFILL / CITY OF MUSKEGO
AUDIT PHOTOS**

PROJECT NO. 1012.10030



Active area viewed from the North



Working face viewed from North, excavation for back haul going on in the background



Access to Phase 7



East edge of Phase 7



Southwest corner of Phase 7B



West slope of Phase 6, seeded and crimped



Working face viewed from the East