



Memorandum

ADS Emerald Park Landfill Audit Summary

To: ADS Emerald Park Landfill Standing Committee, City of Muskego
FROM: Faith Spear.
COPIES: File
DATE: 06/02/15
PROJECT NUMBER: 1012.10030

Attached is the audit report for activities at the ADS Emerald Park Landfill for the week of May 4, 2015. The audit was performed at 2:25 PM on **May 8, 2015**, by Jo Spear, Jr. in the presence of Michael Hackney, General manager.

Landfill Operations Audit:

The following conditions were noted during this Audit of the VEPL Facility:

- Main working face in Phase 7B, on outboard South slope
 - Receiving MSW, special wastes and C&D materials
- Bio-soils currently being tipped in a secondary working face in Phase 3
- One compactor, two dozers and one water truck in use during audit
- Site soils used for daily cover

- All leachate discharging to MMSD; no recirculation
- No gas flow to MMSD during audit due to regeneration
 - High moisture content in ambient air causing need for more frequent regeneration
 - One flare in operation
 - One blower in operation
 - vegetation in fair condition

- Minor rain event since last audit; less than an inch
 - Site staff preparing for rain forecast for this weekend
 - Basin 3 received the most runoff and is the fullest
- Odors on-site, especially near working face
- Liquid loads periodic

- Litter on-site; clear off-site
 - Site litter mainly confined to fences
 - Four pickers at work during audit
 - Pickers especially active after high winds on 5/7/15
- US 45 and 8 Mile Road clean; site roads gritty and rough

- Scale camera in use; 3 equipment operators; no spotter

Attachments:

Action Items List / Landfill Operations Audit Form
Audit Photos

- Receiving approximately 2,900 tpd
 - Large volume of Bio-soil this week; 3251 tons
- No rejected loads
- Residential drop-off site clean
 - Roll off had been emptied during the work day
 - E-waste container present

Comments:

- Bio soil loads expected to remain more frequent
 - Back hauled soils kept separate from incoming loads
- Soil erosion repairs are on-going
 - Contractor on-site seeding during audit
 - Will follow with straw to hold seed

Attachments:

Action Items List / Landfill Operations Audit Form
Audit Photos

VEOLIA Emerald Park Landfill
Action Items Checklist
City of Muskego Audit

Opened:

Updated: 01/09/2014 - Cleared

| Item Number | DATE month/date/year | Condition Description | Permit or Contract Reference | Initial Schedule for Completion | Observed Completion Date | Elapsed Time (Days) | Notes |
|-------------|-------------------------|-----------------------|------------------------------------|--|--------------------------------|---------------------------|-------|
| | | | | | | | |
| | | | | | | | |
| | | | | | | | |
| | | | | | | | |
| | | | | | | | |
| | | | | | | | |
| | | | | | | | |
| | | | | | | | |
| | | | | | | | |



ADVANCED DISPOSAL SERVICES EMERALD PARK LANDFILL
 LANDFILL OPERATIONS AUDIT FORM
 CITY OF MUSKEGO

PROJECT NO. 1020.10030

DATE May 8, 2015

TIME 2:25

Auditor on site at: Open Close

WEATHER Low clouds, high humidity storms WIND D-10
 N E

TEMP Maximum 79 °F Minimum 47 °F B.P. 29.94

MAJOR EQUIPMENT USED IN LANDFILL OPERATIONS

| No. | DESCRIPTION | Rented | Contracted | No. | DESCRIPTION | Rented | Contracted |
|----------|-------------|--------|------------|-----|-------------|--------|------------|
| <u>1</u> | Compactor | | | | | | |
| <u>2</u> | Dozer | | | | | | |
| | Excavator | | | | | | |
| | Haul Truck | | | | | | |
| <u>1</u> | Water Truck | | | | | | |
| | Grader | | | | | | |

MAJOR EQUIPMENT BONEYARD

| No. | DESCRIPTION | Broken | Maintenance | No. | DESCRIPTION | Broken | Maintenance |
|-----|-------------|--------|-------------|-----|-------------|--------|-------------|
| | | | | | | | |
| | | | | | | | |
| | | | | | | | |

A. Working Face Size and Location:

Working face in Phase 7B, on out board, South
slope receiving MSW and special
waste along with C&D materials
Another working face in Phase 3 for
Bio soil flipping



Cover Material:

Side soils for slope

B. Leachate Management:

Discharge to MMSD Recirculation

Phases:

C. Gas Monitoring and Management: Check appropriate box.

| | | | | |
|-----------------------------|---|--|-------------------------------|-------------------------------|
| Flares in Operation: | YES <input checked="" type="checkbox"/> | NO <input type="checkbox"/> | # | 1 |
| Blowers in Operation: | YES <input checked="" type="checkbox"/> | NO <input type="checkbox"/> | # | 1 |
| Flare use since last audit | # | Regen | | |
| Shutdowns Since Last Audit: | # | Regen | | |
| Flow to MMSD: | # | | cfm | |
| Vegetation Condition: | Good <input type="checkbox"/> | Fair <input checked="" type="checkbox"/> | Poor <input type="checkbox"/> | Dead <input type="checkbox"/> |

Comments:

Do to moisture in the ambient air the facility will regen more frequently

D. Surface Water Management:

| | | | |
|-------------------------|-----|-------------|-----|
| Storm Events Since Last | # 1 | Est. Volume | <1" |
|-------------------------|-----|-------------|-----|

EFFECTS: Note condition of perimeter road, erosion control structures, erosion damage and possible storm water/waste contact locations:

Minor rain event since last audit
Site preparing for storm events this weekend

E. Odor Control:

Odors Present: Onsite Offsite

Comments:

Minor odors about working face

F. Liquid Loads Received:

Periodic

G. Litter Control:

| | | | |
|-------------------------|---|--|-----|
| Litter Present Onsite: | YES <input checked="" type="checkbox"/> | NO <input type="checkbox"/> | |
| Litter Present Offsite: | YES <input type="checkbox"/> | NO <input checked="" type="checkbox"/> | |
| Pickers Active: | YES <input checked="" type="checkbox"/> | NO <input type="checkbox"/> | # 4 |

Comments:

Pickers active after high winds on 5/7/15
 Site litter minimal and in fences

H. Vehicle Impacts: Locations of excessive mud/dust, condition of access and public roads and control measures taken, instances of trucks on County roads.

US 41 for 1/2 mile clean, site roads gritty, rough

I. Inspection of incoming Waste:

| | | | | |
|-------------------------------|---|--|---|---|
| Scale Camera Operator: | YES <input checked="" type="checkbox"/> | NO <input type="checkbox"/> | # | |
| Equipment Operator: | YES <input checked="" type="checkbox"/> | NO <input type="checkbox"/> | # | 3 |
| Spotter: | YES <input type="checkbox"/> | NO <input checked="" type="checkbox"/> | # | |
| Random Load Inspection Dates: | | | | |
| Tonnage: | 2,900 TSD | | | |

Comments:

Large volume of Bio Soil this week, 3,251 tons

J. Rejected Loads:

| | Date/Time | Reason for Rejection |
|----|-----------|----------------------|
| 1. | | None |
| 2. | | |

| | | |
|-----------------------|---|---|
| Residential Drop Off: | Open During Audit <input checked="" type="checkbox"/> | E-Waste Container Present <input checked="" type="checkbox"/> |
|-----------------------|---|---|

Drop off clean, all of completed during the day

M. Other Comments:

* Backhaul for ~~bio soil~~, separate from bio soil delivery. Bio soil expected to be ongoing

* Side surface repair ongoing contractor on site seeding during audit. Will follow with straw as tackifier.

Auditor's Signature:  Date: 5/8/15

Auditor's Printed Name: John W. Spear, Jr.

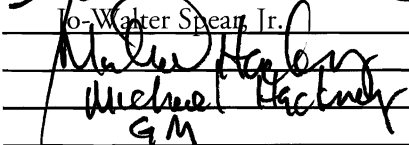
Management Signature:  Date: 5/8/15

Management Printed Name: Michael Mackney

Management Title: GM

JSA Principal Signature: _____ Date: _____

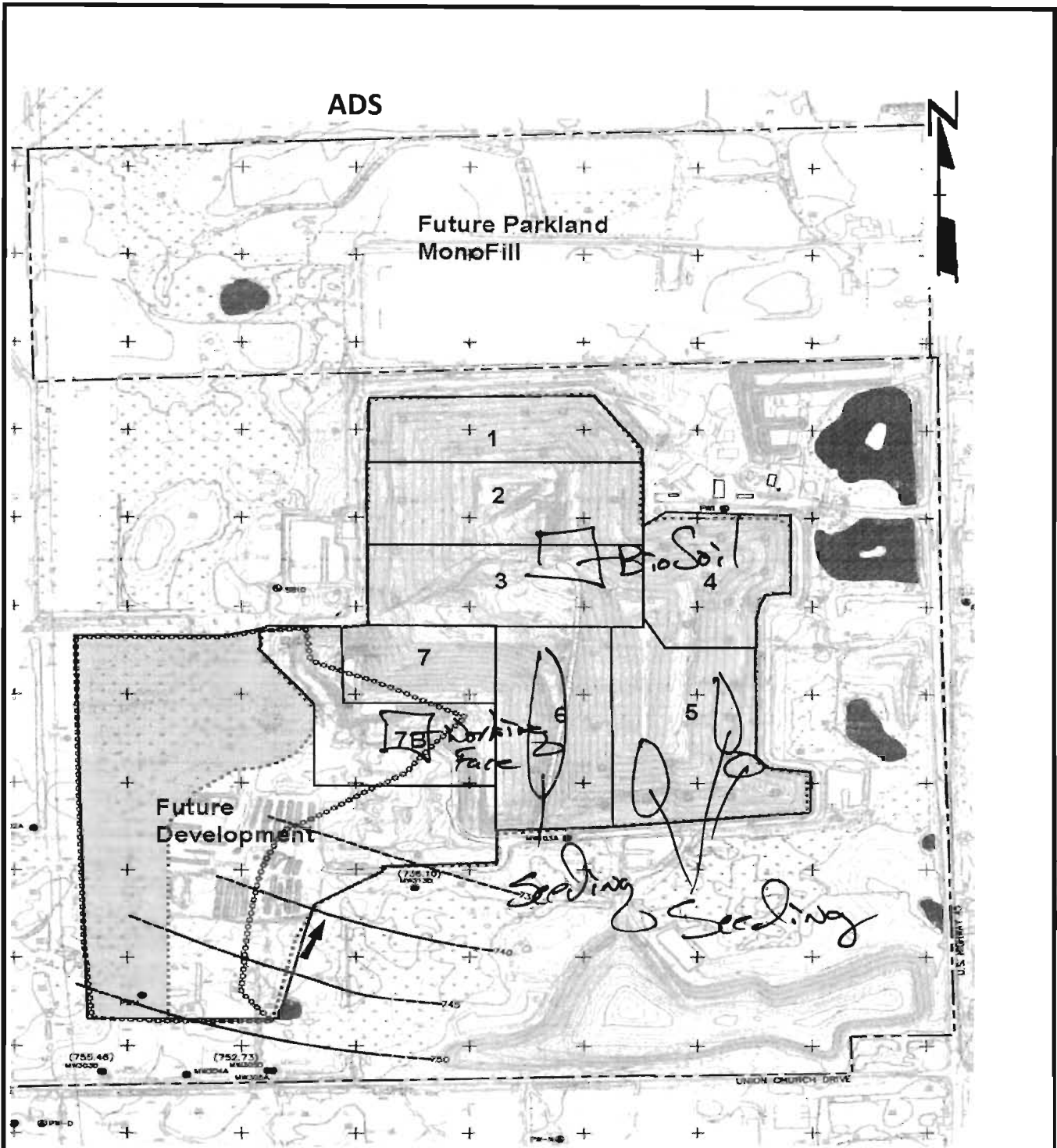

Advanced Disposal Services Emerald Park Landfill
 Landfill Audit Map
 City of Muskego
 Project No. 1020.10030



**ADVANCED DISPOSAL SERVICES
EMERALD PARK LANDFILL / CITY OF MUSKEGO
AUDIT PHOTOS**

PROJECT NO. 1012.10030



Bio soil tipping in Phase 3



West end of Phase 7



Working face viewed from North and above



Access to Phase 7



Active area viewed from the North



Seeding of the West slope of Phase 6



Working face viewed from the East