



Memorandum

ADS Emerald Park Landfill Audit Summary

To: ADS Emerald Park Landfill Standing Committee, City of Muskego
FROM: Faith Spear.
COPIES: File
DATE: 04/28/15
PROJECT NUMBER: 1012.10030

Attached is the audit report for activities at the ADS Emerald Park Landfill for the week of April 13, 2015. The audit was performed at 11:19 AM on **April 17, 2015** by Jo Spear, Jr. in the presence of Michael Hackney, General Manager.

Landfill Operations Audit:

The following conditions were noted during this Audit of the VEPL Facility:

- Working face in Northeast corner of Phase 7B
 - Small active working area receiving MSW, C&D and Special Wastes
 - No other working areas on site
- One compactor, one dozer and one excavator at work on site
- C&D, sand, plastic fluff and soils used for daily cover

- All leachate discharging to MMSD; no recirculation
- Gas flow to MMSD restored; approximately 1,400 cfm
 - Gas plant brought back in service on 4/7/15
 - One shut down since last audit
 - One blower in operation; no flares in use
 - Vegetation in fair condition

- One storm event since last audit; about 4”
 - Site in good condition
- Slopes prepared for seeding
 - Seeding by June 1st
- Repairs still needed on Closure Area III

- No odors
- Periodic liquid loads tipped in Phase 1
- Some litter present on-site
 - Two pickers working
 - One operating residential drop-off site
- US 45 and 8 Mile Road clean; site roads gritty

Attachments:

Action Items List / Landfill Operations Audit Form
Audit Photos

- Scale camera in use; equipment operators; no spotter
 - Receiving approximately 1,500 tpd of MSW, special wastes and C&Ds
 - Random load inspection 4/17/15
 - No rejected loads
- Residential drop-off site clean
 - E-waste container present
 - Site very busy
 - Users have been abusive to staff

Comments:

- Large soil job expected to deliver next week
 - 111,000 tons; approximately 3,000 tons per day
 - May extend hours to accommodate
- 40 yard roll-off spilled on US 45 on 4/10/15
 - Clean-up appears complete
- Resident struck dumpster with vehicle in residential drop-off area
- DNR inspected site on 4/16/154
 - Good report

Attachments:

Action Items List / Landfill Operations Audit Form
Audit Photos

VEOLIA Emerald Park Landfill
Action Items Checklist
City of Muskego Audit

Opened:

Updated: 01/09/2014 - Cleared

Item Number	DATE month/date/year	Condition Description	Permit or Contract Reference	Initial Schedule for Completion	Observed Completion Date	Elapsed Time (Days)	Notes



ADVANCED DISPOSAL SERVICES EMERALD PARK LANDFILL
 LANDFILL OPERATIONS AUDIT FORM
 CITY OF MUSKEGO

PROJECT NO. 1020.10030

DATE April 17, 2015
 Auditor on site at: Open Close

TIME 11:19
W!

WEATHER Clear Sunny, Spring Day

WIND N S E W

TEMP Maximum 70 °F Minimum 46 °F

B.P. 30.08

MAJOR EQUIPMENT USED IN LANDFILL OPERATIONS

No.	DESCRIPTION	Rented	Contracted	No.	DESCRIPTION	Rented	Contracted
1	Compactor						
1	Dozer						
1	Excavator						
	Haul Truck						
	Water Truck						
	Grader						

MAJOR EQUIPMENT BONEYARD

No.	DESCRIPTION	Broken	Maintenance	No.	DESCRIPTION	Broken	Maintenance
	<u>None</u>						

A. Working Face Size and Location:

Working face in Northeast corner of these 7B
small working face receiving MSW, C&D, and
special waste. No other working faces



Cover Material:

3D, Sand, Plastic Luff Ground Soil

B. Leachate Management:

Discharge to MMSD	<input checked="" type="checkbox"/>	Recirculation	<input type="checkbox"/>
-------------------	-------------------------------------	---------------	--------------------------

Phases:

C. Gas Monitoring and Management: Check appropriate box.

Flares in Operation:	YES <input type="checkbox"/>	NO <input checked="" type="checkbox"/>	#	
Blowers in Operation:	YES <input checked="" type="checkbox"/>	NO <input type="checkbox"/>	#	1
Flare use since last audit	#		1	
Shutdowns Since Last Audit:	#		1	
Flow to MMSD:	#		1,100	cfm
Vegetation Condition:	Good <input type="checkbox"/>	Fair <input checked="" type="checkbox"/>	Poor <input type="checkbox"/>	Dead <input type="checkbox"/>

Comments:

Gas building & leaking since 1/7/15

D. Surface Water Management:

Storm Events Since Last	#	1	Est. Volume	4"
-------------------------	---	---	-------------	----

EFFECTS: Note condition of perimeter road, erosion control structures, erosion damage and possible storm water/waste contact locations:

Site in good condition. Slopes prepared seeding by June. ~~By~~ Repairs still needed on Closure Area III

E. Odor Control:

Odors Present:	Onsite <input type="checkbox"/>	Offsite <input type="checkbox"/>
----------------	---------------------------------	----------------------------------

Comments:

No odors

F. Liquid Loads Received:

Periodic to this

G. Litter Control:

Litter Present Onsite:	YES <input checked="" type="checkbox"/>	NO <input type="checkbox"/>	
Litter Present Offsite:	YES <input type="checkbox"/>	NO <input checked="" type="checkbox"/>	
Pickers Active:	YES <input checked="" type="checkbox"/>	NO <input type="checkbox"/>	# 2

Comments:

Litter minimal

1 picker running residropoff

H. Vehicle Impacts: Locations of excessive mud/dust, condition of access and public roads and control measures taken, instances of trucks on County roads.

US 45 & 8 Mile Clean,

Site roads gritty

I. Inspection of incoming Waste:

Scale Camera Operator:	YES <input checked="" type="checkbox"/>	NO <input type="checkbox"/>	#	
Equipment Operator:	YES <input checked="" type="checkbox"/>	NO <input type="checkbox"/>	#	
Spotter:	YES <input type="checkbox"/>	NO <input checked="" type="checkbox"/>	#	
Random Load Inspection Dates:	6/12/15			
Tonnage:	1,500			

Comments:

HSW, Special, C&D

J. Rejected Loads:

	Date/Time	Reason for Rejection
1.		None
2.		

Residential Drop Off:	Open During Audit <input checked="" type="checkbox"/>	E-Waste Container Present <input checked="" type="checkbox"/>
-----------------------	---	---

Site clean and very active. Site users have been abou side

M. Other Comments:

- * Large soil job west deck 111,000 tons at 3000 tons per day. Man stay open later
- * 40 yard roll off spilled on US45 on 4/10/15, cleanup appears complete
- * Resident struck vehicle into dumpster in resi drop off area
- * Site inspected by DNR on 4/16/15 good report

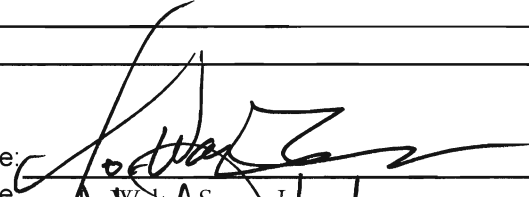
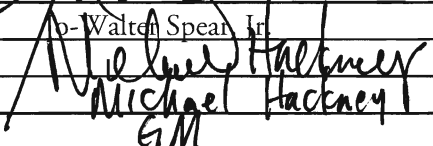
Auditor's Signature: 
Auditor's Printed Name: Walter Spear, Jr.
Management Signature: 
Management Printed Name: Michael Hackney
Management Title: GM
JSA Principal Signature: _____

Date: 4/17/15
Date: 4/17/15
Date: _____

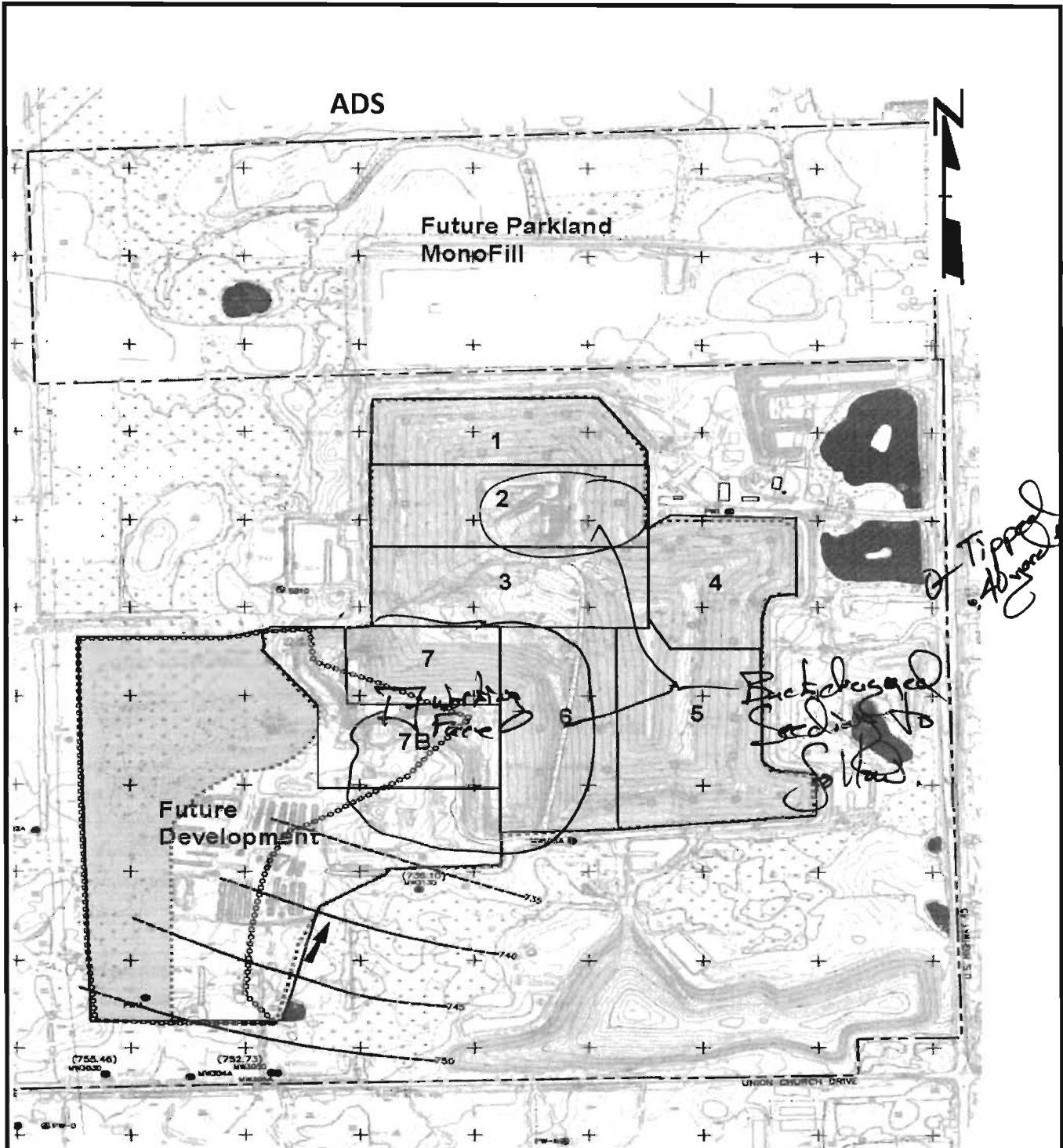

Advanced Disposal Services Emerald Park Landfill
 Landfill Audit Map
 City of Muskego
 Project No. 1020.10030



**ADVANCED DISPOSAL SERVICES
EMERALD PARK LANDFILL / CITY OF MUSKEGO
AUDIT PHOTOS**

PROJECT NO. 1012.10030



Phase 1,2,&3 top and exposed slopes dressed up



Phase 4 Northeast slope, backdragged.



Overview from the North



Working face viewed from North



Site South of footprint, compost facility and future expansion area